

⚠ Warnings

⚠ Follow the **instructions for use of your injection pen** and only use these needles for your injection pen after consultation with your physician.

⚠ **Avoid infections.** Do not use the needle if the seal is damaged or has been opened by someone other than you. Do not use the needle after the expiration date on the packaging has expired. Before injection clean the area thoroughly according to your physician's instruction. Put the outer protective cap carefully on the needle after each injection in order to avoid unintentional needle-sticks. Twist off the needle immediately after injecting and dispose of the used needle safely, so that no one can prick and infect themselves. Use the needle only once. The needle must not be re-used, cleaned and/or re-sterilized. If these instructions are not followed, there is a risk of infection. In case of an infection immediately seek medical attention.

⚠ **Ensure correct delivery of medicinal dosage.** Check before injecting that the needle allows a free flow by priming the device according to the instructions for use of your injection pen. This will prevent incorrect dosage caused by air entering the cartridge or a clogged needle.

⚠ Inject slowly according to your physician's and injection pen manufacturer's instruction to ensure that the prescribed dosage is fully delivered.

⚠ Check after each injection whether liquid drips from the needle or the injection pen, or whether liquid escapes from the injection channel. If after the injection liquid drips from the needle or the injection pen, or escapes from the injection channel, follow your physician's instructions regarding the handling of a potential under-dosage. Seek medical attention in case of any uncertainties.

⚠ Once the needle has broken the skin surface, do not change the angle of the injection pen. A subsequent change in the angle of the injection pen can result in the **needle bending or breaking**. A broken needle can become stuck in the body or disappear under the skin. If the needle breaks and remains in the body, you must seek immediate medical attention.

Caution (please note)

! Change the injection site regularly in accordance with the advice of your physician. If this is not done, tissue hardening may result.

! Click-on or twist-on the -needle at a right angle.

! Consult your physician for the right needle length for you.

! The Penfine universal click pen needle can either be simply clicked or twisted on. When the needle is twisted on, a secure fit is ensured even if there is no noticeable stop.

! The Penfine universal click is a pen needle that fits on all -listed injection pens. Please contact us if you have any questions on how to use the Penfine universal click with another injection pen.

! Please note the special instructions for employees in health systems.

The listed pens are trademarks of the named manufacturers.

¹ The Novo Nordisk function test cannot be carried out with the Penfine universal click pen needle.

² Twist on the needle.

³ The injection-pen cap can be replaced only once the needle has been removed.

1



3

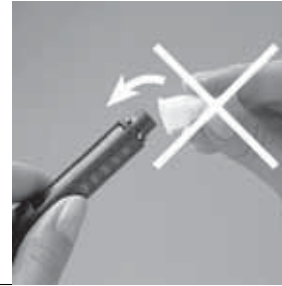

5



7



2

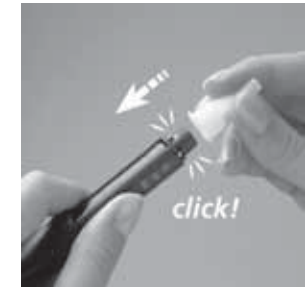

4



6



8



Fits on:

NovoPen® 3

NovoLet®

Innovo®

InnoLet®

SoloStar®

B-DPen®

HumaPen® LUXURA

HumePen® Ergo

HumaJect®

HumaJet® Pen

AutoPen®



Distributor:

Auto Control Medical Inc.
1.800.461.0991
www.autocontrol.com



Manufacturer:

Ypsomed AG
Brunnmattstrasse 6
CH-3401 Burgdorf
Switzerland
www.ypsomed.com

CE 1250

Made in Switzerland